

Title Report	
Property Information	
State	New Mexico
County	Valencia
Assessor's Parcel Number #	1-018-032-475-280-100240
Owner Name	B. Scott Todd, TTEE, Everland Capital Partners 2 Land Trust
Mailing Address	1936 Bruce B Downs Blvd #551, Wesley Chapel, FL 33544
Complete Legal Description	
Rio Del Oro Lot 24 Block 12 Unit 2	
Tax Information	
Total Taxes \$12.50 on Tax Year 2023. It's Paid.	
Chain of Title	
Chain of Title - Deed #1	
Deed Type	Warranty Deed
Document ID Number (Book/Page)	2022-9884
Date	8/2/2022
Grantee	B. Scott Todd, TTEE, Everland Capital Partners 2 Land Trust
Grantor	John L Abernathy
Chain of Title - Deed #2	
Deed Type	Warranty Deed
Document ID Number (Book/Page)	2022-4683
Date	4/5/2022
Grantee	John L Abernathy
Grantor	Dream Land Buying LLC
Chain of Title - Deed #3	
Deed Type	Warranty Deed
Document ID Number (Book/Page)	2022-3345
Date	3/14/2022
Grantee	Dream Land Buying LLC
Grantor	Charlene J Dimacali
Chain of Title - Deed #4	
Deed Type	Warranty Deed
Document ID Number (Book/Page)	2005-8497
Date	5/10/2005
Grantee	Charlene J Dimacali
Grantor	Douglas A Kennedy
Chain of Title - Deed #5	
Deed Type	Warranty Deed
Document ID Number (Book/Page)	2005-3314
Date	2/24/2005
Grantee	Douglas A Kennedy
Grantor	Valley Improvement Association Inc
LIENS	
Open Lien #1	
Document Title	No Lien Found
Document ID Number (Book/Page)	
Date	
Loan Amount	
Borrower	
Lender	
Notes	
No Taxes Due. No Other Lien found against the Property.	

Property Profile

Valencia County

Account: R198264

Tax Year: 2024

Account Type:

Mill Levy: 27.953000

Version: 03/13/2024

Area ID: BN02\_NR

Estimated Tax: \$5.00

Parcel: 1-018-032-475-280-100240

Map Number: C-6-25

\*This mill levy is from the most recent tax roll

Status: Active

Name and Address Information

TODD B SCOTT TTEE  
C/O EVERLAND CAPITAL PARTNERS 2  
LAND TRUST  
1936 BRUCE B DOWNS #551  
WESLEY CHAPEL, FL 33544

Property Location

No Location Information Available

Legal Description

Subd: RIO DEL ORO Lot: 24 Block: 12 Unit: 2

Assessment Information					
2024	Actual	Assessed	Sq Ft	Acres	Taxable
Land	500	167		0.330	
Improvements					
Exempt		0			
Total	500	167		0.330	167
2023	Actual	Assessed	Sq Ft	Acres	Taxable
Land	1,330	443		0.330	
Improvements					
Exempt					
Total	1,330	443			443

User Remarks

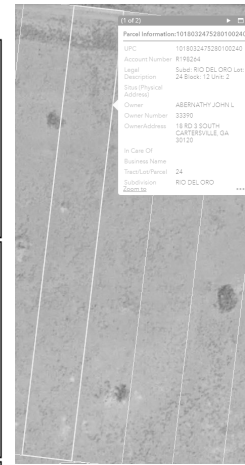

# Tax Account

## Summary

Account Id     R198264  
Parcel Number 1018032475280100240  
Owners        TODD B SCOTT TTEE  
Address       1936 BRUCE B DOWNS #551  
                  WESLEY CHAPEL, FL 33544  
Situs Address  
Legal          Subd: RIO DEL ORO Lot: 24 Block: 12 Unit: 2

## Inquiry

As Of            04/24/2024 

Payment Type   ☐ First  
                      ☒ Full

Total Due \$0.00

## Value

Area Id	Mill Levy	
BN02_NR - CITY OF BELEN OUT- NR	27.9530000	
	Actual	Assessed
NON-RES LAND - 0200	1,330	443
Taxes		\$12.38
	Area Id	Taxes
Special Assessment	SWCD - SWCD	\$0.12
<hr/>		
Total Billed		\$12.50

The amounts of taxes due on this page are based on **last year's** property value assessments.  
For current year values visit the [Valencia County Assessor's site.](#)



# Valencia County Treasurer

## Statement of Taxes Due

Account Number R198264

Assessed To

Parcel 1018032475280100240

TODD B SCOTT TTEE  
C/O:EVERLAND CAPITAL PARTNERS 2 LAND TRUST  
1936 BRUCE B DOWNS #551  
WESLEY CHAPEL, FL 33544

### Legal Description

### Situs Address

Subd: RIO DEL ORO Lot: 24 Block: 12 Unit: 2

Year	Tax	Adjustments	Interest	Fees	Payments	Balance
<b>Tax Charge</b>						
2023	\$12.38	\$0.00	\$0.12	\$0.00	(\$12.50)	\$0.00
2022	\$9.50	\$0.00	\$0.48	\$0.00	(\$9.98)	\$0.00
2021	\$8.96	\$0.00	\$1.52	\$0.00	(\$10.48)	\$0.00
2020	\$2.68	\$0.00	\$0.78	\$2.28	(\$5.74)	\$0.00
2019	\$2.68	\$0.00	\$0.00	\$2.28	(\$4.96)	\$0.00
2018	\$2.70	\$0.00	\$0.00	\$2.26	(\$4.96)	\$0.00
2017	\$2.70	\$0.00	\$0.00	\$2.26	(\$4.96)	\$0.00
2016	\$2.68	\$0.00	\$0.00	\$2.28	(\$4.96)	\$0.00
2015	\$2.70	\$0.00	\$0.00	\$2.26	(\$4.96)	\$0.00
2014	\$2.98	\$0.00	\$0.00	\$1.98	(\$4.96)	\$0.00
Total Tax Charge						\$0.00
<b>Special Assessment: SOIL &amp; WATER CONSERVATION</b>						
2021	\$0.08	\$0.00	\$0.01	\$0.46	(\$0.55)	\$0.00
2020	\$0.04	\$0.00	\$0.01	\$0.14	(\$0.19)	\$0.00
2019	\$0.04	\$0.00	\$0.00	\$0.00	(\$0.04)	\$0.00
2018	\$0.04	\$0.00	\$0.00	\$0.00	(\$0.04)	\$0.00
2017	\$0.04	\$0.00	\$0.00	\$0.00	(\$0.04)	\$0.00
2016	\$0.04	\$0.00	\$0.00	\$0.00	(\$0.04)	\$0.00
2015	\$0.04	\$0.00	\$0.00	\$0.00	(\$0.04)	\$0.00
2014	\$0.00	\$0.04	\$0.00	\$0.00	(\$0.04)	\$0.00
Total Special Assessment: SOIL & WATER CONSERVATION						\$0.00
<b>Special Assessment: SWCD</b>						
2023	\$0.12	\$0.00	\$0.00	\$0.13	(\$0.25)	\$0.00
2022	\$0.08	\$0.00	\$0.00	\$0.49	(\$0.57)	\$0.00
Total Special Assessment: SWCD						\$0.00
<b>GRAND TOTAL</b>						<b>\$0.00</b>
<b>Grand Total Due as of 04/24/2024</b>						<b>\$0.00</b>

Tax Billed at 2023 Rates for Tax Area BN02\_NR - CITY OF BELEN OUT- NR

Authority	Mill Levy	Amount	Values	Actual	Assessed
BELEN SCHOOLS NR_SCHOOLDIST	1.3860000	\$0.61	NON-RES LAND	\$1,330	\$443
BELEN SCHOOLS NR_SCHOOLDIST	7.6030000	\$3.37	Total	\$1,330	\$443
BELEN SCHOOLS NR_SCHOOLDIST	0.3470000	\$0.15			
BELEN SCHOOLS NR_SCHOOLDIST	2.0000000	\$0.89			
COUNTY DEBT	0.7070000	\$0.31			
COUNTY OPERATIONAL NON-RES	11.8500000	\$5.25			
STATE BOARD OF FINANCE- STA	1.3600000	\$0.60			
UNM VALENCIA BLDG LEVY	0.7000000	\$0.31			
UNM VALENCIA BRANCH-NR	2.0000000	\$0.89			
Taxes Billed 2023		27.9530000	\$12.38		

**SWCD**

**\$0.12**

All payments are subject to final clearance.



# VALENCIA COUNTY TREASURER

## RECEIPT OF TAX PAYMENT

Account	Parcel Number	Receipt Date	Receipt Number
R198264	1018032475280100240	Dec 21, 2023	2023-12-21-LAS-1009259

TODD B SCOTT TTEE  
1936 BRUCE B DOWNS #551  
WESLEY CHAPEL, FL 33544

Situs Address	Payor
	TODD B SCOTT TTEE 1936 BRUCE B DOWNS #551 WESLEY CHAPEL, FL 33544

### Legal Description

Subd: RIO DEL ORO Lot: 24 Block: 12 Unit: 2

### Payments Received

Check Multi-Account Payment  
Check Number 0413  
Payor everland equity

### Payments Applied

Year	Charges	Billed	Prior Payments	New Payments	Balance
2023	Penalty	\$0.13	\$0.00	\$0.13	\$0.00
2023	Interest	\$0.12	\$0.00	\$0.12	\$0.00
2023	Special Assessment	\$0.12	\$0.00	\$0.12	\$0.00
2023	Tax	\$12.38	\$0.00	\$12.38	\$0.00
				\$12.75	\$0.00
Balance Due as of Dec 21, 2023					\$0.00

## Tax Account

### Summary

Tax Year	Tax Due	Interest Due	Penalty Due	Misc Due	Lien Due	Lien Interest Due	Total Due
2023	\$0.00	\$0.00	\$0.00	\$0.00	\$0.00	\$0.00	\$0.00

### Transaction Details

Tax Year	Type	Effective Date	Amount	Balance
2023	Penalty Payment	12/21/23	\$0.13	\$0.00
2023	Interest Payment	12/21/23	\$0.12	\$0.00
2023	Special Assessment Payment	12/21/23	\$0.12	\$0.00
2023	Tax Payment	12/21/23	\$12.38	\$0.00
2023	Penalty	12/21/23	\$0.13	\$0.00
2023	Interest	12/21/23	\$0.12	\$0.00
2023	Special Assessment	10/4/23	\$0.12	\$0.00
2023	Tax	10/4/23	\$12.38	\$0.00
2020	Miscellaneous Payment	4/27/23	\$2.28	\$0.00
2020	Penalty Payment	4/27/23	\$0.14	\$0.00
2020	Interest Payment	4/27/23	\$0.78	\$0.00
2020	Interest Payment	4/27/23	\$0.01	\$0.00
2020	Tax Payment	4/27/23	\$2.68	\$0.00
2020	Special Assessment Payment	4/27/23	\$0.04	\$0.00
2021	Penalty Payment	4/27/23	\$0.46	\$0.00
2021	Interest Payment	4/27/23	\$1.52	\$0.00
2021	Interest Payment	4/27/23	\$0.01	\$0.00
2021	Tax Payment	4/27/23	\$8.96	\$0.00
2021	Special Assessment Payment	4/27/23	\$0.08	\$0.00
2022	Penalty Payment	4/27/23	\$0.49	\$0.00
2022	Interest Payment	4/27/23	\$0.48	\$0.00
2022	Tax Payment	4/27/23	\$9.50	\$0.00
2022	Special Assessment Payment	4/27/23	\$0.08	\$0.00
2020	Penalty	4/27/23	\$0.14	\$0.00
2020	Interest	4/27/23	\$0.78	\$0.00
2020	Interest	4/27/23	\$0.01	\$0.00
2021	Penalty	4/27/23	\$0.46	\$0.00
2021	Interest	4/27/23	\$1.52	\$0.00
2021	Interest	4/27/23	\$0.01	\$0.00
2022	Penalty	4/27/23	\$0.49	\$0.00
2022	Interest	4/27/23	\$0.48	\$0.00
2022	Special Assessment	10/5/22	\$0.08	\$0.00
2022	Tax	10/5/22	\$9.50	\$0.00
2021	Special Assessment	10/5/21	\$0.08	\$0.00
2021	Tax	10/5/21	\$8.96	\$0.00
2020	Special Assessment	10/1/20	\$0.04	\$0.00
2020	Tax	10/1/20	\$2.68	\$0.00
2020	Miscellaneous	10/1/20	\$2.28	\$0.00
2019	Special Assessment Payment	11/27/19	\$0.04	\$0.00
2019	Tax Payment	11/27/19	\$2.68	\$0.00

<b>Tax Year</b>	<b>Type</b>	<b>Effective Date</b>	<b>Amount</b>	<b>Balance</b>
2019	Miscellaneous Payment	11/27/19	\$2.28	\$0.00
2019	Special Assessment	10/1/19	\$0.04	\$0.00
2019	Tax	10/1/19	\$2.68	\$0.00
2019	Miscellaneous	10/1/19	\$2.28	\$0.00
2018	Tax Payment	11/30/18	\$2.70	\$0.00
2018	Special Assessment Payment	11/30/18	\$0.04	\$0.00
2018	Miscellaneous Payment	11/30/18	\$2.26	\$0.00
2018	Special Assessment	10/2/18	\$0.04	\$0.00
2018	Tax	10/2/18	\$2.70	\$0.00
2018	Miscellaneous	10/2/18	\$2.26	\$0.00
2017	Special Assessment Payment	11/22/17	\$0.04	\$0.00
2017	Tax Payment	11/22/17	\$2.70	\$0.00
2017	Miscellaneous Payment	11/22/17	\$2.26	\$0.00
2017	Special Assessment	10/2/17	\$0.04	\$0.00
2017	Tax	10/2/17	\$2.70	\$0.00
2017	Miscellaneous	10/2/17	\$2.26	\$0.00
2016	Miscellaneous Payment	12/6/16	\$2.28	\$0.00
2016	Special Assessment Payment	12/6/16	\$0.04	\$0.00
2016	Tax Payment	12/6/16	\$2.68	\$0.00
2016	Special Assessment	10/3/16	\$0.04	\$0.00
2016	Tax	10/3/16	\$2.68	\$0.00
2016	Miscellaneous	10/3/16	\$2.28	\$0.00
2015	Special Assessment Payment	11/12/15	\$0.04	\$0.00
2015	Tax Payment	11/12/15	\$2.70	\$0.00
2015	Miscellaneous Payment	11/12/15	\$2.26	\$0.00
2015	Special Assessment	10/2/15	\$0.04	\$0.00
2015	Tax	10/2/15	\$2.70	\$0.00
2015	Miscellaneous	10/2/15	\$2.26	\$0.00
2014	Tax Payment	12/3/14	\$2.98	\$0.00
2014	Miscellaneous Payment	12/3/14	\$1.98	\$0.00
2014	Special Assessment Payment	12/3/14	\$0.04	\$0.00
2014	Tax Adjustment	10/14/14	\$2.98	\$0.00
2014	Tax Adjustment	10/14/14	(\$2.98)	\$0.00
2014	Miscellaneous	10/14/14	\$1.98	\$0.00
2014	Miscellaneous	10/14/14	(\$2.02)	\$0.00
2014	Special Assessment	10/14/14	\$0.04	\$0.00
2014	Tax	10/7/14	\$2.98	\$0.00
2014	Miscellaneous	10/7/14	\$2.02	\$0.00
2013	Tax Payment	11/5/13	\$2.98	\$0.00
2013	Miscellaneous Payment	11/5/13	\$2.02	\$0.00
2013	Tax	10/7/13	\$2.98	\$0.00
2013	Miscellaneous	10/7/13	\$2.02	\$0.00
2012	Tax Payment	12/10/12	\$2.99	\$0.00
2012	Miscellaneous Payment	12/10/12	\$2.01	\$0.00
2012	Tax	10/1/12	\$2.99	\$0.00
2012	Miscellaneous	10/1/12	\$2.01	\$0.00
2011	Tax Payment	12/10/11	\$3.02	\$0.00
2011	Miscellaneous Payment	12/10/11	\$1.98	\$0.00
2011	Tax	10/1/11	\$3.02	\$0.00
2011	Miscellaneous	10/1/11	\$1.98	\$0.00

<b>Tax Year</b>	<b>Type</b>	<b>Effective Date</b>	<b>Amount</b>	<b>Balance</b>
2010	Tax Payment	12/10/10	\$2.96	\$0.00
2010	Miscellaneous Payment	12/10/10	\$2.04	\$0.00
2010	Tax	10/1/10	\$2.96	\$0.00
2010	Miscellaneous	10/1/10	\$2.04	\$0.00
2009	Tax Payment	12/10/09	\$2.98	\$0.00
2009	Miscellaneous Payment	12/10/09	\$2.02	\$0.00
2009	Tax	10/1/09	\$2.98	\$0.00
2009	Miscellaneous	10/1/09	\$2.02	\$0.00
2008	Tax Payment	12/10/08	\$3.01	\$0.00
2008	Miscellaneous Payment	12/10/08	\$1.99	\$0.00
2008	Tax	10/1/08	\$3.01	\$0.00
2008	Miscellaneous	10/1/08	\$1.99	\$0.00
2007	Tax Payment	11/19/07	\$3.02	\$0.00
2007	Miscellaneous Payment	11/19/07	\$1.98	\$0.00
2007	Tax	10/1/07	\$3.02	\$0.00
2007	Miscellaneous	10/1/07	\$1.98	\$0.00
2006	Tax Payment	12/10/06	\$2.61	\$0.00
2006	Miscellaneous Payment	12/10/06	\$2.39	\$0.00
2006	Tax	10/1/06	\$2.61	\$0.00
2006	Miscellaneous	10/1/06	\$2.39	\$0.00
2005	Interest	6/23/06	\$0.19	\$0.00
2005	Interest Payment	6/23/06	\$0.19	\$0.00
2005	Penalty	6/23/06	\$0.13	\$0.00
2005	Penalty Payment	6/23/06	\$0.13	\$0.00
2005	Tax Payment	6/23/06	\$2.66	\$0.00
2005	Miscellaneous Payment	6/23/06	\$2.34	\$0.00
2005	Tax	10/1/05	\$2.66	\$0.00
2005	Miscellaneous	10/1/05	\$2.34	\$0.00
2004	Interest	5/9/05	\$0.13	\$0.00
2004	Interest Payment	5/9/05	\$0.13	\$0.00
2004	Penalty	5/9/05	\$0.13	\$0.00
2004	Penalty Payment	5/9/05	\$0.13	\$0.00
2004	Tax Payment	5/9/05	\$2.64	\$0.00
2004	Miscellaneous Payment	5/9/05	\$2.36	\$0.00
2003	Interest	5/9/05	\$0.43	\$0.00
2003	Interest Payment	5/9/05	\$0.43	\$0.00
2003	Penalty	5/9/05	\$0.13	\$0.00
2003	Penalty Payment	5/9/05	\$0.13	\$0.00
2003	Tax Payment	5/9/05	\$2.51	\$0.00
2003	Miscellaneous Payment	5/9/05	\$2.49	\$0.00
2004	Tax	10/1/04	\$2.64	\$0.00
2004	Miscellaneous	10/1/04	\$2.36	\$0.00
2003	Tax	10/1/03	\$2.51	\$0.00
2003	Miscellaneous	10/1/03	\$2.49	\$0.00

The amounts of taxes due on this page are based on **last year's** property value assessments.  
For current year values visit the [Valencia County Assessor's site](#).